

sim. DIN 7504 - **WS 9165** Self drilling screws type K

hexagon head with collar and EPDM-washers Ø16mm

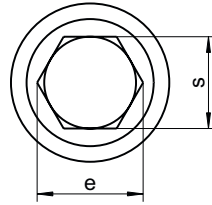
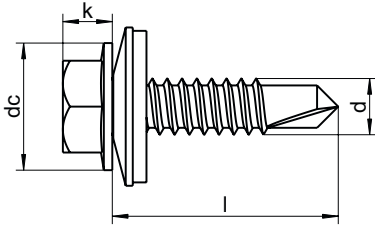

| | | | | | | |
|-------------------|--------------|--------------|--------------|--------------|--------------|--------------|
| dc max. | 8,3 | 8,3 | 8,8 | 10,5 | 11,0 | 13,2 |
| k max. | 3,4 | 3,4 | 4,1 | 4,3 | 5,45 | 5,9 |
| e min. | 5,96 | 5,96 | 7,59 | 8,71 | 8,71 | 10,95 |
| s | 6 | 7 | 7 | 8 | 8 | 10 |
| ● | 6 | 7 | 7 | 8 | 8 | 10 |
| Length / Ø | ST3,5 | ST3,9 | ST4,2 | ST4,8 | ST5,5 | ST6,3 |
| 9,5 (3/8") | ▲ | | | | | |
| 13 (1/2") | ▲ | ▲ | ▲ | ▲ | ▲ | ▲ |
| 16 (5/8") | ▲ | ▲ | ▲ | ▲ | ▲ | ▲ |
| 19 (3/4") | ▲ | ▲ | ▲ | ▲ | ▲ | ▲ |
| 22 (7/8") | ▲ | ▲ | ▲ | ▲ | ▲ | ▲ |
| 25 (1") | ▲ | ▲ | ▲ | ▲ | ▲ | ▲ |
| 28 (1 1/8") | | | ▲ | ▲ | ▲ | ▲ |
| 30 (1 3/16") | | | ▲ | ▲ | ▲ | ▲ |
| 32 (1 1/4") | | | ▲ | ▲ | ▲ | ▲ |
| 35 (1 3/8") | | | | ▲ | ▲ | ▲ |
| 38 (1 1/2") | | | | ▲ | ▲ | ▲ |
| 45 (1 3/4") | | | | ▲ | ▲ | ▲ |
| 50 (2") | | | | ▲ | ▲ | ▲ |
| 60 (2 3/8") | | | | | ▲ | |
| 70 (2 3/4") | | | | | ▲ | |
| 80 (3 3/8") | | | | | ▲ | |
| 90 (3 1/2") | | | | | ▲ | |
| 100 (4") | | | | | ▲ | |
| SU | 200 | 200 | 200 | 200 | 200 | 200 |

■ A1 / ▲ A2 / ● A4 | VE: Sales units | All Measures in mm / inch | Other measures on request

Example item no. 9165-2-5,5X32 WS 9165 - A2 - Ø 5,5mm - l = 32mm

Please note that self drilling screws in stainless steel are mainly suitable for the processing in aluminium and thin stainless steel sheets. Self drilling screws with hexagon head and EPDM-washer WS 9165 with other dimensions and A4 are available on request. Self drilling screws with hexagon head, and collar without sealing washer can be found as DIN 7504 K in this catalogue.