



ROUND STEEL LONG LINK CHAINS, ACC. TO DIN 763



DATA SHEET
M8301

IHRE VERBINDUNG ZUM ERFOLG
YOUR ACCESS TO SUCCESS

M8301

TECHNICAL SPECIFICATIONS

Stainless steel round link chains are mostly used in corrosive environments, such as in the chemical, food, medical and pharmaceutical industries. In addition, due to

their attractive appearance and low maintenance requirements, they are also used in architecture, outdoor areas and for barriers.

However, they must **not be** used as a means of attachment or support.

Material	Stainless Steel
Material class	A4 (1.4401) - AISI 316
Surface	pickled and polished
Measurements	< Ø 4mm nach DIN 5685-1 ≥ Ø 4mm nach DIN 763

ADVANTAGES



VERSATILE AND UNIVERSALLY APPLICABLE

E.G. AS BARRIER CHAIN, RAIN DRAIN CHAIN, HANGING, ETC.



HIGH DURABILITY

CORROSION RESISTANCE IS INCREASED BY PICKLING AND POLISHING

WE'LL BE PLEASED TO ADVISE FOR YOUR APPLICATION.

T +49(0)202 / 26 32-0
info@wasi.de
www.wasi.de



DIMENSIONS (MM)

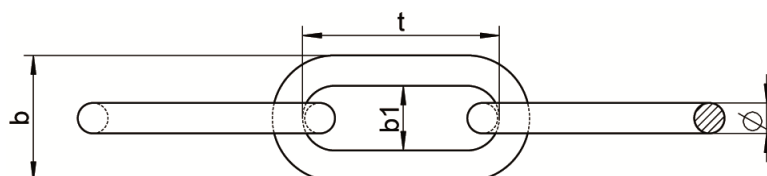

\emptyset mm		Inside length t mm		b1 min./mm	b2 max./mm	weight Kg/m
2	$\pm 0,10$	22	$\pm 1,1$	3,6	8,2	0,06
3	$\pm 0,15$	26	$\pm 1,3$	5,4	12,2	0,14
4	$\pm 0,20$	32	$\pm 1,0$	7,2	16,8	0,26
5	$\pm 0,25$	35	$\pm 1,1$	9,0	21,0	0,42
6	$\pm 0,30$	42	$\pm 1,3$	10,8	25,2	0,61
7	$\pm 0,35$	49	$\pm 1,5$	12,0	29,2	0,82
8	$\pm 0,40$	52	$\pm 1,6$	14,4	33,6	1,1
10	$\pm 0,50$	65	$\pm 2,0$	18,0	42,0	1,7
13	$\pm 0,65$	82	$\pm 2,5$	23,4	54,6	2,9

SAFETY INSTRUCTIONS



- › Chains according to or similar to DIN 5685-1 and DIN 763 must not be used as load or load-bearing equipment.

WE'LL BE PLEASED TO ADVISE FOR YOUR APPLICATION.

T +49(0)202 / 26 32-0
info@wasi.de
www.wasi.de

