

DIN 923

Slotted pan head screws

with shoulder

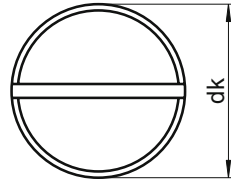
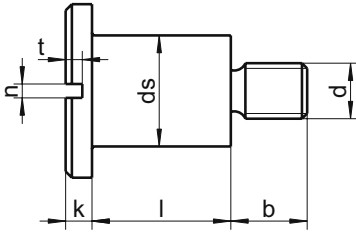

dk	7,0	8,5	11,0	13,0	16,0
k	1,8	2,4	2,7	3,1	3,8
n	0,8	1,0	1,2	1,6	2,0
t min.	0,9	1,2	1,3	1,5	1,9
b	4,5	6,0	7,0	9,0	11,0
ds	4,0	5,5	7,0	8,0	10,0
⌀	0,8X4,0	1,0X5,5	1,2X7,0	1,6X9,0	2,0X12,0
Length / Ø	M3	M4	M5	M6	M8
3	■	■	■	■	
4	■	■	■	■	
5	■	■	■	■	
6	■	■	■	■	
8	■	■	■	■	■
10	■	■	■	■	■
12	■	■	■	■	■
16	■	■	■	■	■
20				■	■
SU	100	100	100	50	50

■ A1 / ▲ A2 / ● A4 | SU: Sales unit | All measurements in mm | Other dimensions on request.

Example item no. 923-2-8X20 DIN 923 - A1 - M8 - l = 20mm