

sim. ISO 1479 - **DIN 7976**
Tapping screws
 hexagon head, type C (with cone point)

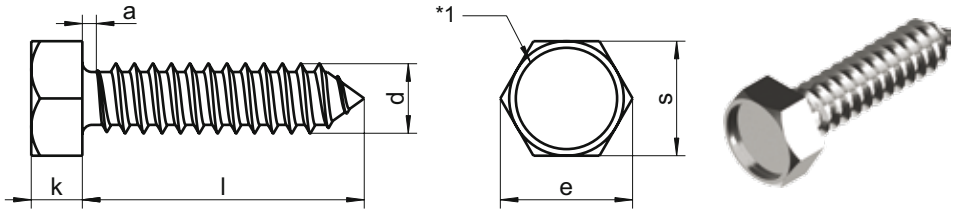

	1,5	2,3	2,3	2,8	3,0	4,0	4,8	5,8
k	1,5	2,3	2,3	2,8	3,0	4,0	4,8	5,8
s	5	5,5	7	7	8	8	10	13
e	5,45	6,00	7,66	7,66	8,79	8,79	11,05	14,38
a	1,1	1,3	1,3	1,4	1,6	1,8	1,8	2,1
●	5	5,5	7	7	8	8	10	13
Length / Ø	ST2,9	ST3,5	ST3,9	ST4,2	ST4,8	ST5,5	ST6,3	ST8
9,5 (3/8")	▲	▲	▲	▲	▲	▲		
13 (1/2")	▲	▲	▲	▲	▲	▲	▲	▲
16 (5/8")	▲	▲	▲	▲	▲	▲	▲	▲
19 (3/4")	▲	▲	▲	▲	▲	▲	▲	▲
22 (7/8")	▲	▲	▲	▲	▲	▲	▲	▲
25 (1")	▲	▲	▲	▲	▲	▲	▲	▲
32 (1 1/4")	▲	▲	▲	▲	▲	▲	▲	▲
38 (1 1/2")	▲	▲	▲	▲	▲	▲	▲	▲
45 (1 3/4")		▲	▲	▲	▲	▲	▲	▲
50 (2")		▲	▲	▲	▲	▲	▲	▲
55 (2 1/8")			▲	▲	▲	▲	▲	▲
60 (2 3/8")			▲	▲	▲	▲	▲	▲
70 (2 3/4")					▲	▲	▲	▲
80 (3 3/8")					▲	▲	▲	▲
90 (3 1/2")					▲	▲	▲	▲
100 (4")					▲	▲	▲	▲
110 (4 3/8")					▲	▲	▲	▲
120 (4 3/4")					▲	▲	▲	▲
SU	1000	1000 ≥ 32 500	1000 ≥ 32 500	1000 ≥ 32 500	500 ≥ 32 200	200 ≥ 32 100	200 ≥ 32 100	200 ≥ 32 100

■ A1 / ▲ A2 / ● A4 | SU: Sales units | All measurements in mm / inch | Other dimensions on request.

Example item no. 7976-2-4,2X38 DIN 7976 - A2 - Ø 4,2mm - l = 38mm - *1 head shape depends on production

Tapping screws with hexagon head DIN 7976, with dog point type F, cutting groove type SB and in A4 are available on request. Tapping screws with hexagon head DIN 7976, with different coatings or head varnishing are available on request. Hexagon tapping screws with assembled polyamide-washer can be found as WS 9230 in this catalogue.