

DIN 6796

Conical spring washers

for screwed connections

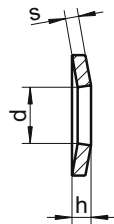
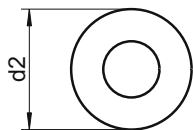

d	for	d2	h min.	h max.	s
3	M3	7	0,72	0,85	0,6
4	M4	9	1,12	1,30	1,0
5	M5	11	1,35	1,55	1,2
6	M6	14	1,70	2,00	1,5
8	M8	18	2,24	2,60	2,0
10	M10	23	2,80	3,20	2,5
12	M12	29	3,43	3,95	3,0
14	M14	35	4,04	4,65	3,5
16	M16	39	4,58	5,25	4,0
18	M18	42	5,08	5,80	4,5
20	M20	45	5,60	6,40	5,0
22	M22	49	6,15	7,05	5,5
24	M24	56	6,77	7,75	6,0

Grade	SU
▲●	200
▲●	200
▲●	200
▲●	200
▲●	200
▲●	200
▲●	100
▲●	100
▲●	100
▲●	100
▲●	100
▲●	100
▲●	50
▲●	50

■ A1 / ▲ A2 / ● A4 | SU: Sales unit | All measurements in mm | Other dimensions on request.

Example item no. 6796-2-8 DIN 6796 - A2 - Ø 8mm