

DIN 427 - sim. ISO 2342

Slotted headless screws

with chamfered end

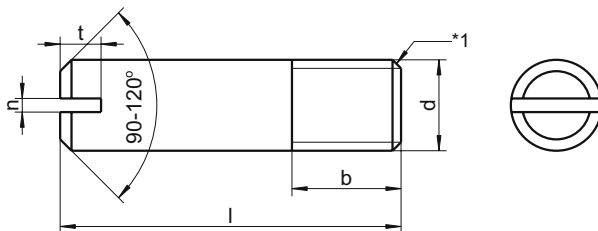

b	3,6	4,8	6,0	7,2	9,6	12,0
n	0,4	0,6	0,8	1,0	1,2	1,6
t min.	1,25	1,75	2,0	2,5	3,1	3,75
t max.	1,50	2,05	2,35	2,90	3,60	4,25
⌀	0,4X2,0	0,6X3,5	0,38X4,0	1,0X5,5	1,2X7,0	1,6X9,0
Length / ⌀	M3	M4	M5	M6	M8	M10
6	■ ●					
8	■ ●	■ ●	■ ●			
10	■ ●	■ ●	■ ●			
12	■ ●	■ ●	■ ●	■ ●		
16	■ ●	■ ●	■ ●	■ ●	■ ●	
20	■ ●	■ ●	■ ●	■ ●	■ ●	■ ●
25	■ ●	■ ●	■ ●	■ ●	■ ●	■ ●
30	■ ●	■ ●	■ ●	■ ●	■ ●	■ ●
35		■ ●	■ ●	■ ●	■ ●	■ ●
40		■ ●	■ ●	■ ●	■ ●	■ ●
45					■ ●	■ ●
SU	200	200	200	100	100	25

■ A1 / ▲ A2 / ● A4 | SU: Sales unit | All measurements in mm | Other dimensions on request.

Example item no. 427-2-8X40 DIN 427 - A1 - M8 - l = 40mm - *1 thread end acc. to DIN 78-k