

DIN 3017 type A

Hose clamps - W2

range 12 mm, with worm gear drive, type A, stainless W2

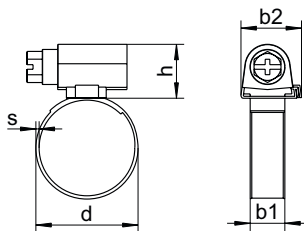

cl. range (d)	b1	b2 max.
16 - 25	12	20
16 - 27	12	20
20 - 32	12	20
23 - 35	12	20
25 - 40	12	20
30 - 45	12	20
32 - 50	12	20
40 - 60	12	20
50 - 70	12	20
60 - 80	12	20
70 - 90	12	20
80 - 100	12	20
90 - 110	12	20
100 - 120	12	20
110 - 130	12	20
120 - 140	12	20
130 - 150	12	20
140 - 160	12	20

Grade	SU
A0	100
A0	100
A0	100
A0	100
A0	100
A0	100
A0	100
A0	100
A0	100
A0	75
A0	60
A0	60
A0	50
A0	30
A0	30
A0	25
A0	20
A0	20
A0	20

■ A1 / ▲ A2 / ● A4 | SU: Sales unit | All measurements in mm | Other dimensions on request.

Example item no. 3017-0-8X16/12 DIN 3017 - band 1.4016 - zinc coated screw - clamping range: 8-16mm - b1 = 12mm